

7. To insert or remove the tablet:

- i. Use the supplied key to unlock the spring-loaded release tab on top of the dock.
- ii. Pull back the tab and insert or remove the tablet.
- iii. Lock the release tab using the key.

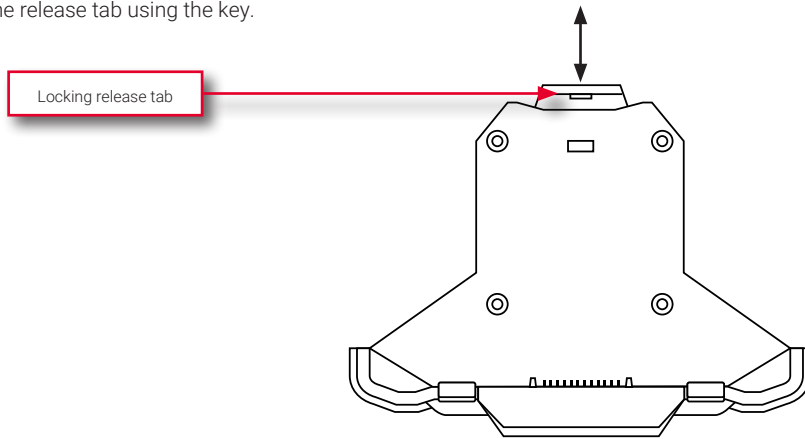

8. Optionally, you can permanently attach the tablet to the docking station, using the supplied docking station screws and washers. To do so:

- i. Thread the supplied locking washers and the O-ring washers onto each screw.
- ii. Insert the screws into the 4 holes on the back of the docking station.
- iii. Align the protruding screws and fit them into the corresponding holes on the back of the tablet, then tighten them using an appropriate tool.

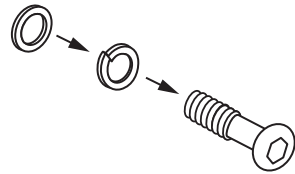

## Service & Support

If your **Mobile Data Terminal** is to be returned for service, please contact the Seon technical support team, provide the part and/or serial # of your unit, and ask for a **Return Merchandise Authorization (RMA)** number.

An **RMA #** allows the support team to better track your product when it comes in for service. Please show the RMA # on the **outside** of the package.

ANY PRODUCT SENT WITHOUT AN RMA # MAY BE REFUSED!

## Documentation and Warranty

Additional copies of this guide along with other documentation and product warranty can be found on the Safe Fleet Community website: <https://community.safefleet.net>

## Technical Support

Phone: 1.844.899.7366

Email: [PTsupport@safefleet.net](mailto:PTsupport@safefleet.net)



2002/96/EC (WEEE directive): This product cannot be disposed of as unsorted municipal waste in the European Union. For proper recycling, return the product to your local supplier upon the purchase of equivalent new equipment, or dispose of it at designated collection points, for more information, see [www.recyclethis.info](http://www.recyclethis.info).

2006/66/EC (battery directive): This product does not contain batteries.

## Product Overview

This guide covers installation of the mobile data terminal (MDT), a portable 7" tablet, intended for use on school buses, transit buses, and commercial vehicles.

## MDT Package Contents

Component
VT-7 Android tablet
VT-7 docking station (includes two lock keys)
USB type C cable (1 pc.)
Docking station screw PM4 x 16mm (4 pcs., includes 1 spring lock washer and 1 O-ring washer per screw)
SD card slot cover screw KM2 x 5mm (2 pcs.)
Hexagon L-key for use with SD card slot cover screws (1 pc.)
Preinserted 64GB microSD card (1 pc.)
Preinserted carrier SIM card (if data option is ordered) (1 pc.)
Mounting assembly: <ul style="list-style-type: none"><li>• Mounting arm kit (includes an arm and two base plates)</li><li>• Tri-groove tamper-resistant nut (1 pc.)</li><li>• Tamper-resistant Torx screws M4-0.70 x 10 (4 pcs.)</li><li>• Spring lock washers M4-4.3 mm ID, 9 mm OD (4 pcs.)</li><li>• Self-tapping security Torx screws #10-1 (4 pcs.)</li></ul>
Power harness kit: <ul style="list-style-type: none"><li>• Cable, 16 AWG, with 2x2 mini-fit connector – 20 ft/6.1 m</li><li>• Butt splice connectors (2 pcs.)</li><li>• Fuses - 3 A (2 pcs.)</li><li>• Fuse holders (2 pcs.)</li></ul>

# Installation diagram

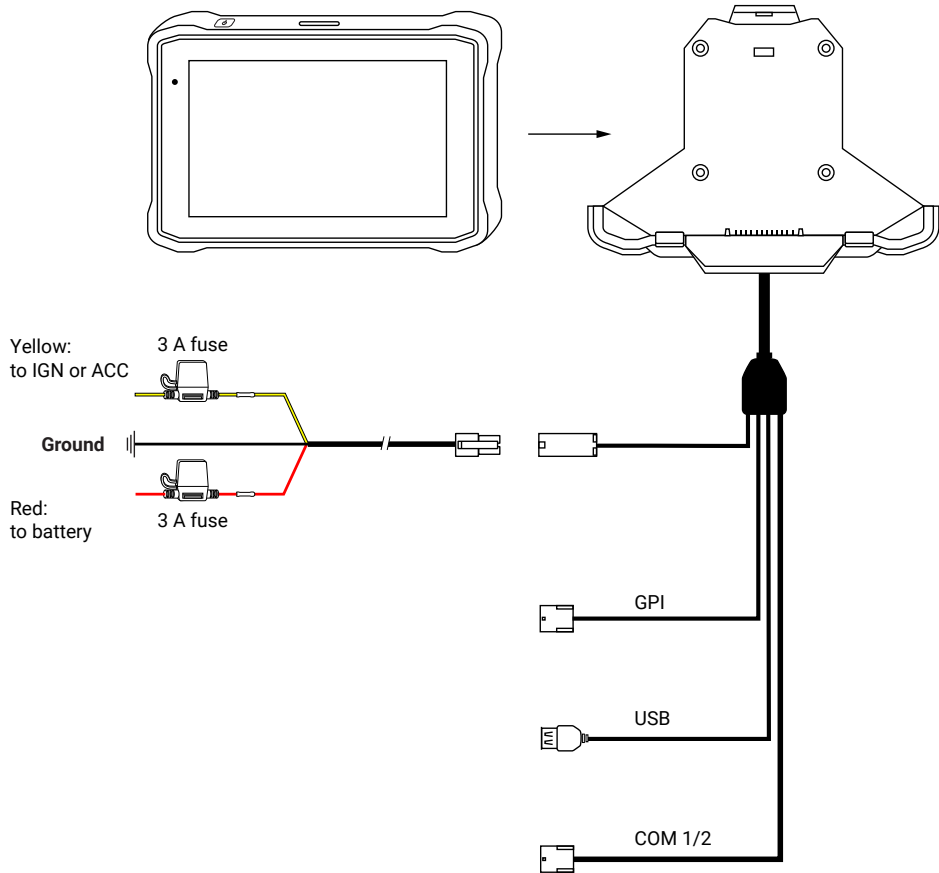

## Installation

### NOTE: Typical installation

The following instructions describe a typical installation that includes the use of the optional mounting arm.

To install MDT:

1. Install the mounting assembly (arm and base) in a preferred location.

### NOTE: Choosing a location

Choose a location where the driver will be able to clearly see the MDT screen. The MDT should have a clear view of the sky to ensure the best GPS and cellular reception.

To do so:

- i. Loosen the tamper-resistant nut on the mounting arm using the tri-groove nut driver, and then detach the base plates.
  - ii. Attach one of the base plates to the mounting surface of the vehicle using the supplied self-tapping Torx screws and the security Torx L-key.
  - iii. Reattach the arm to the base plate, and then lightly tighten the tri-groove tamper-resistant nut.
2. Attach the other base plate to the back of the dock, using the supplied Torx screws and spring lock washers.

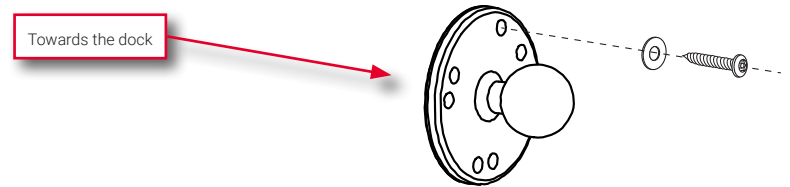

3. Attach the dock-mounted base plate to the mounting arm, adjust the position of the dock, and then tighten the tri-groove tamper-resistant nut.
4. Run the power cable to the source and connect as follows:
  - Black wire to ground
  - Red wire to vehicle's battery via the supplied fuse holder, using the supplied butt splice
  - Yellow wire to vehicle's IGN or ACC via the supplied fuse holder, using the supplied butt splice.
5. Connect the power harness's 2x2 minifit connector to the pigtail power port.
6. Take a note of the device ID: write down the last 8 digits of the IMEI number located on the white barcode sticker attached to the bottom of the tablet.

