

# SEON

## SA-MIC Remote Microphone

---

# Setup Guide

## Service and Warranty

If your product is to be returned to Seon Design for service, please call toll free 877-630-7366, or 604-524-6437 and ask for a Return Authorization (RA) number. An RA number allows the Service Technicians to better track your product when it comes in for service. Please show the RA number on the outside of the package. ANY PRODUCT SENT TO SEON DESIGN WITHOUT AN RA NUMBER MAY BE REFUSED.

Please refer to the Warranty form provided with your product to review the terms of warranty service, contact and shipping information, as well as other important issues regarding the service and operation of your product.

© 2003 Seon Design Inc. All rights reserved.  
Document Part Number: 700-0010-01

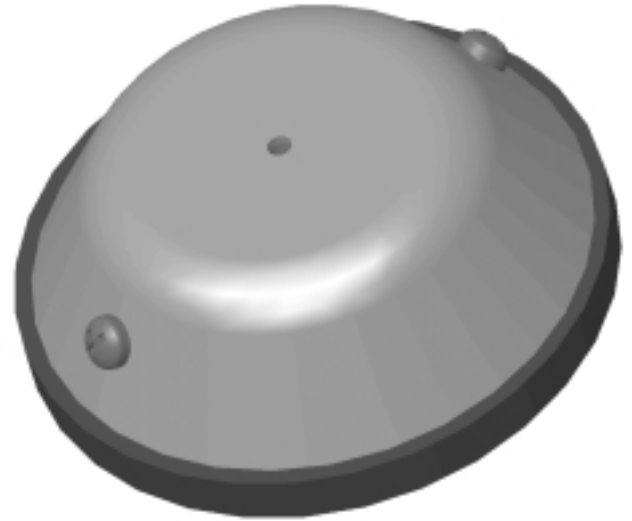

## 1 Features

The SA-MIC is a high quality, impact resistant remote microphone that installs easily into a variety of locations. With the use of the base adapter gasket, the SA-MIC can be installed with the cable concealed or surface-run.

## 2 Installation

- 1 The first step in installing the SA-MIC is to decide if the cable will be concealed into the panel or wall behind the microphone, or if the cable will be run along the mounting surface. If the cable is to be surface-run, then the base adapter gasket should be cut with a pair of scissors or a sharp knife at the edge of the cable grommet hole. See **Figure 1** at the right.
- 2 **Figure 2** below shows the assembly of the SA-MIC. Use the mounting template shown in **Figure 3** to drill pilot holes for the #10 mounting screws included in the hardware kit. Also, if the cable is to be concealed, drill a hole in the mounting surface for the cable connectors to pass through.
- 3 For easier installation, the cable can be removed from the microphone by using a small slot screwdriver to undo the connections from the terminal blocks. Refer to **Figure 4** for the wiring connections to the terminal blocks on the SA-MIC circuit board.
- 4 Mount the SA-MIC base using the two #10 rubber washers and two #10 x 3/4" sheet metal screws provided. Make sure the gasket is properly aligned.
- 5 Install the SA-MIC cover using the two #6-32 x 1/4" machine screws provided. Install one side first, but do not tighten the screw. Install the screw in the second side, and then tighten both screws.

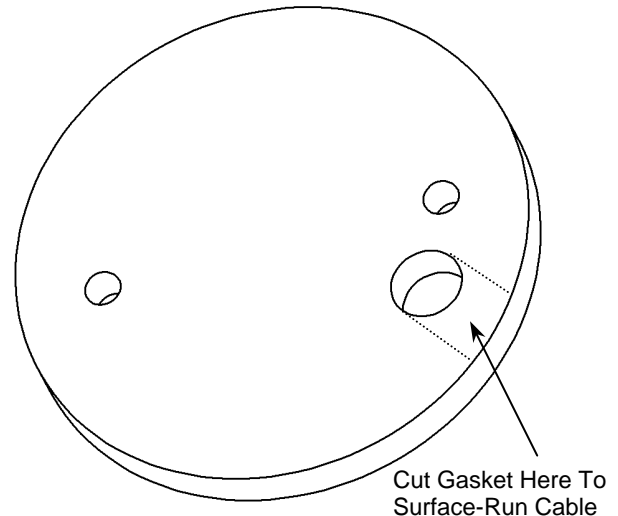

Figure 1: Base Adapter Gasket

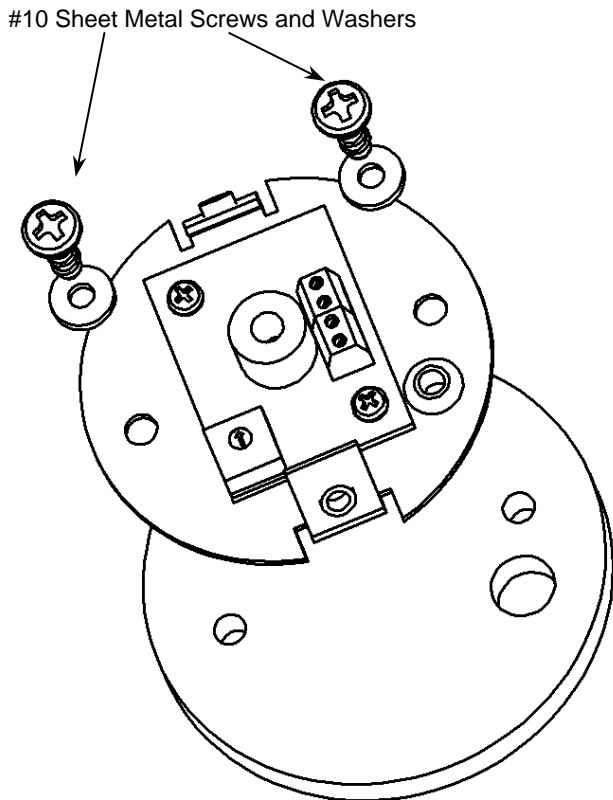

Figure 2: SA-MIC Installation

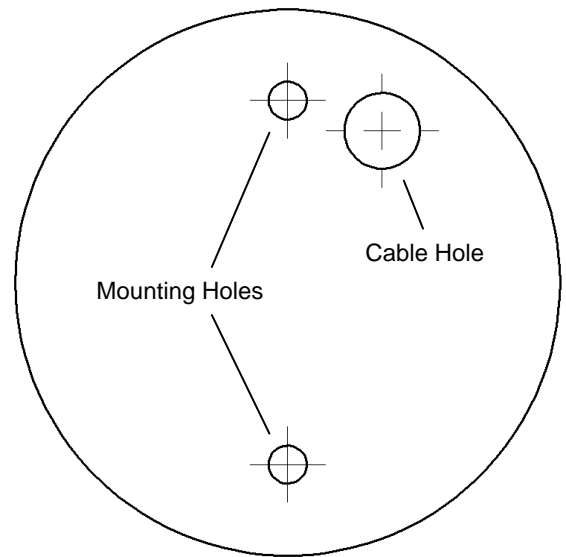

Figure 3: Mounting Template (Actual Size)

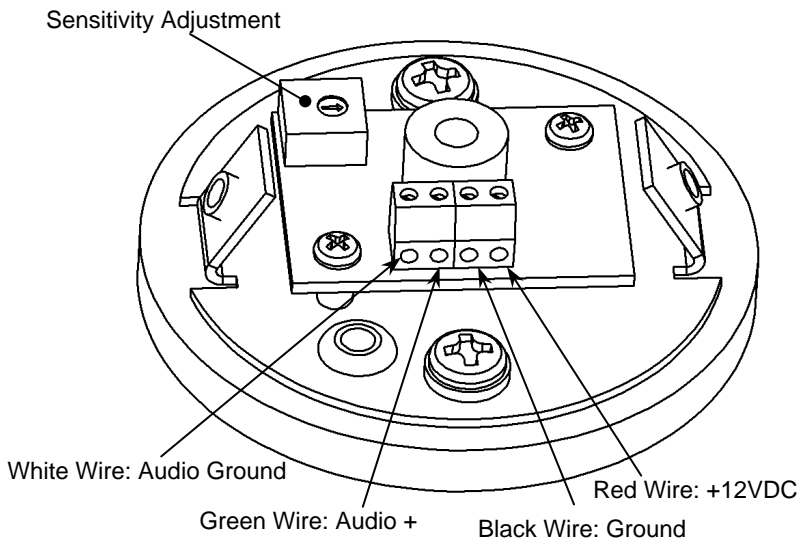

Figure 4: Terminal Block Wiring

### 3 Operation

The SA-MIC powers from 12VDC and provides a line-level audio signal for direct interfacing with many devices, including video cassette recorders, digital video recorders, monitors, etc. The only adjustment on the SA-MIC is the sensitivity. The default sensitivity is set in the middle of the control. Turning the control clockwise will increase the sensitivity. Some environments can be very noisy; set the sensitivity to a safe level that will not overload the receiving device under normal operating conditions.

### 4 Specifications

Frequency response:	200 Hz – 5 kHz
Sensitivity:	-45 dB
Audio Output:	Line level
Minimum Load:	600 ohm
Operating Voltage Range:	8 VDC – 18 VDC
Operating Temperature Range:	14°F to 140°F -10°C to 60°C
Enclosure Size:	2.75" (70 mm) diameter 0.75" (19 mm) height
Gasket Size:	2.875" (73 mm) diameter 0.25" (6.5 mm) thick
Cable Length:	30 ft (9.1 m)
Audio Connector:	RCA, red
Power Connector:	2.1 mm barrel - center positive
Weight:	4.5 oz (125 g) - without cable 13.5 oz (375 g) - with cable