

# Smart-Reach Lite



## Installation Guide

## Introduction

The Smart-Reach Lite Wi-Fi bridge and the included antenna connect the Seon mobile recorder to a wireless network. The bridge requires 12-volt PoE (Power over Ethernet) to operate. Depending on your order, installation may also require a PoE Injector (supplied with the SRLAC07 and SRLN07 kits).

### 12-volt PoE Support - Installation Kits

**Seon TH Series and TL-HD recorders support 12-volt PoE.** These installations use the **SRLAC07NP** and **SRLN07NP** kits. Power is supplied to the Smart-Reach Lite through the Ethernet cable connected to the recorder's rear-panel Wi-Fi port.

**Connecting the Smart-Reach Lite to a recorder without 12-volt PoE support requires installation of a PoE Injector** (supplied with the **SRLAC07** and **SRLN07** kits). For details, see "Appendix: PoE Injector Installation (SRLAC07/SRLN07)" on page 7.

## Kit contents (SRLAC07NP, SRLN07NP)

- Smart Reach Lite Wi-Fi bridge (032-1038 or 032-1043)
- Mounting bracket (660-1077)
  - Screws (x2) and Zip ties (x2)
- Antenna (085-1002)
- Red 25-foot (7.6m) Ethernet patch cable (085-1071)

## Location requirements

Find appropriate component installation locations meeting these requirements:

- The antenna should be installed on top of the bus, in a location with the best visibility to the access point antenna - typically in the middle of the roof on the front of the bus.
- The antenna must be installed within 6ft./1.8m of the Smart-Reach Lite.
- The Smart-Reach Lite must be installed in a dry location.
- If a PoE Injector is installed, it must be in a dry location, and within 3ft/.9m of the recorder.

## Tools and equipment

Ensure you have all system components and inspect the units for scratches or damage before installing.

Required installation tools:

- 5/16" ratchet socket or wrench
- 3/4" hole saw or step bit (for metal or plastic)

# General Installation Diagram (SRLAC07NP, SRLN07NP)

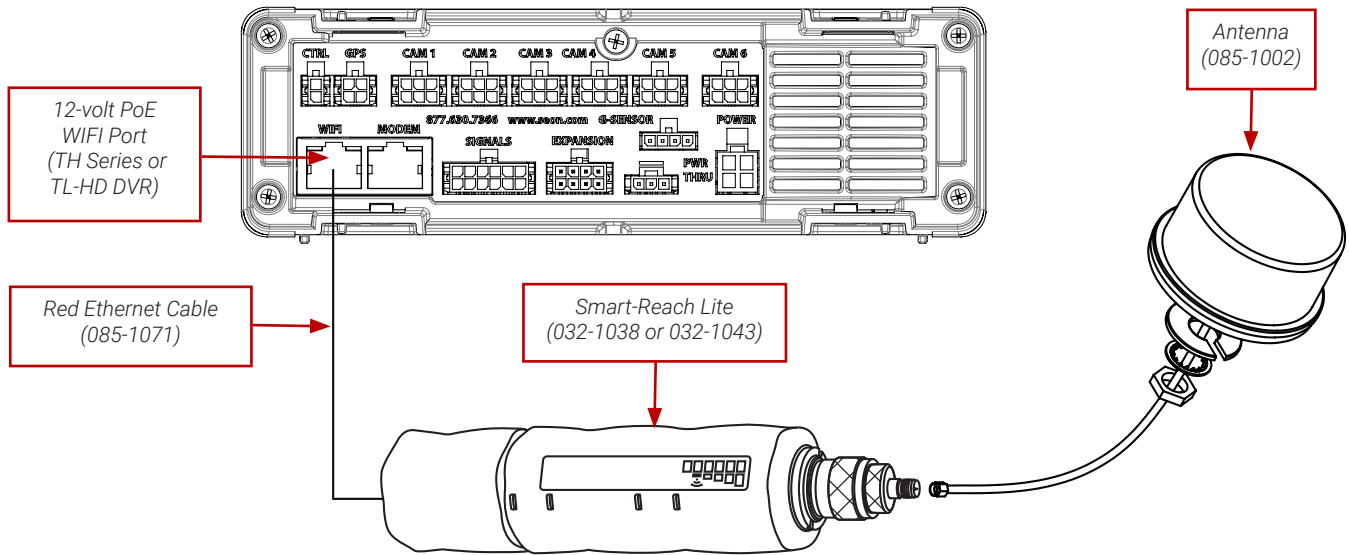

## Install the Antenna

Refer to the following diagram and procedure:

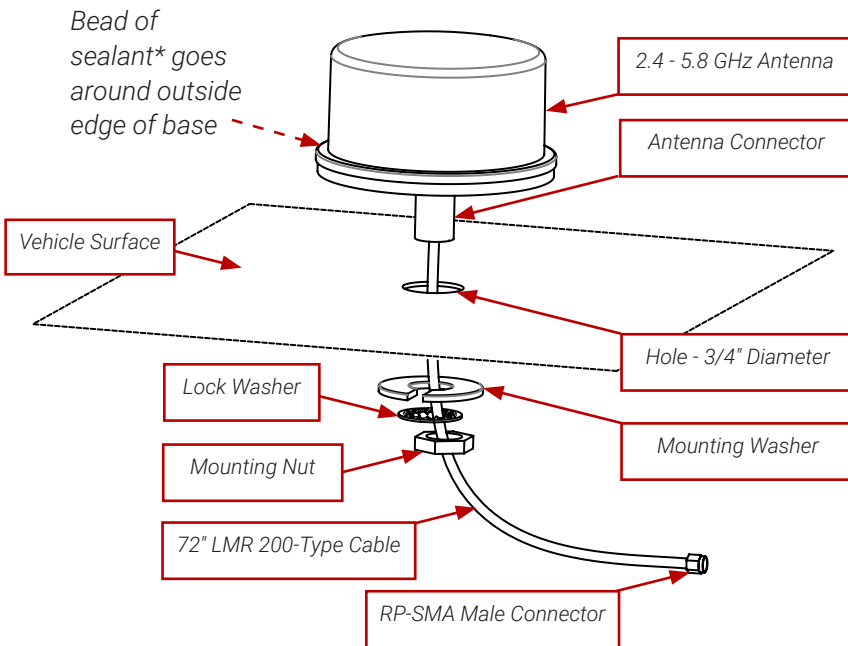

1. Drill a 3/4" hole on a flat vehicle surface.
2. Remove any hole-cutting burrs.
3. From the outside of the vehicle, seat the antenna's threaded connector through the vehicle hole.
4. Inside the vehicle, thread the washer, lock washer, and nut onto the connector.
5. Tighten the nut until it stops firmly on the lockwasher and washer (60 in-lbs. or 6.8 Nm maximum). Do not overtighten.
6. Lay a bead of sealant\* around the outside edge of the antenna base to prevent moisture ingress.

\* We recommend Sikaflex 25X Marine Grade Sealant, which resists shrinkage.

## Connect Wi-Fi Bridge Cables

Refer to the General Installation diagram on page 3, and use the following images and procedure to make the cable connections.

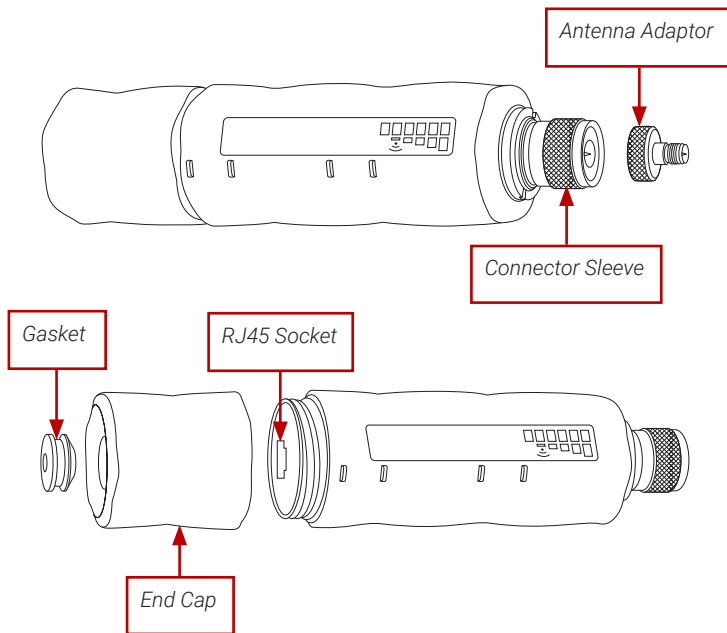

1. Thread the antenna adaptor (RP-SMA-FEM to N-FEM) into the connector sleeve on the end of the Smart-Reach Lite.
2. Connect the antenna cable to the tip of the adaptor.
3. Unthread the end cap and remove the gasket.
4. Pass the Ethernet cable (25ft./7.6m - 085-1071) jack through the end cap and connect the cable to the RJ45 socket.

### 12-Volt PoE Support

Only the TH Series and TL-HD recorders support 12-volt PoE. If you are NOT connecting to one of these recorders:

- Skip step 5 below, then complete steps 6 and 7.
- Install the Wi-Fi bridge (see page 5).
- Install the PoE Injector (see the Appendix on page 7).
- Configure the system (see page 5).

5. Connect the other end of the Ethernet cable to the recorder's 12-volt PoE WIFI port.
6. Thread the cap back onto the Smart Reach Lite.
7. Put the gasket around the cable and replace the gasket in the end cap.

## Install the Wi-Fi Bridge

Secure the bridge to the mounting surface using the mounting bracket/screws and zip ties as follows:

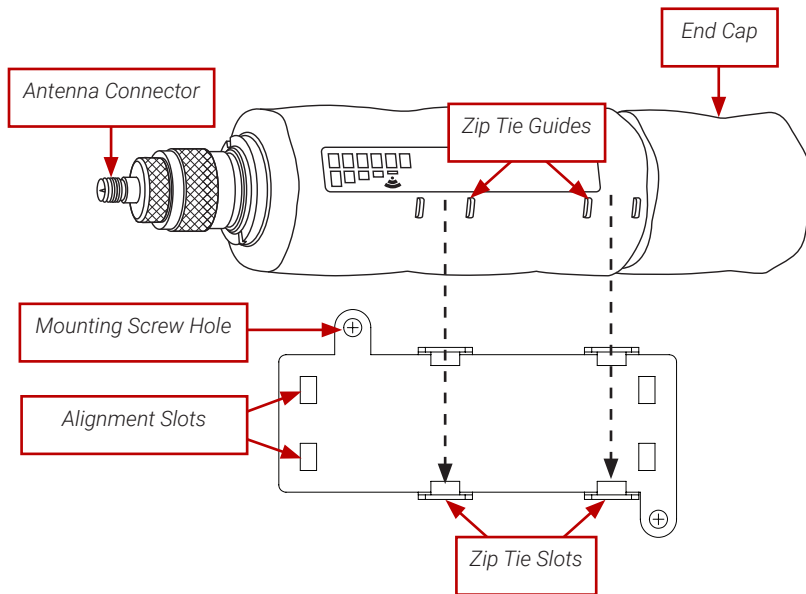

### Orient the Bridge on the Mounting Bracket

The bridge fits on the bracket in only one way, as shown above.

1. Select a location for the bridge with access to the cable connections on both ends. Ensure the signal strength LEDs are visible.
2. Locate a surface to fasten the mounting bracket.
3. Use a 5/16" hex driver to drill the self-tapping screws. Ensure there are no cables behind the mounting location.
4. With the bridge oriented on the bracket as shown, thread the zip ties through the bracket slots.
5. Place the bridge in position and tighten the ties until the device is stable.

When servicing the bridge, do not remove the mounting bracket: cut the zip ties and use new ones to replace the bridge when the service task is complete.

## Configure the System

The Smart-Reach Lite comes preconfigured for your network. Stickers on the bridge provide site-specific information. If you have questions, please contact Technical Support.

The following recorder settings must be configured properly:

- Network settings must be configured as per instructions from the Service team.
- Power Off Delay time should be set long enough to allow video to be downloaded after the vehicle ignition is turned off (typically two hours).

## Power on the system

Turn on the vehicle ignition to power up the components.

### Smart-Reach Lite LEDs

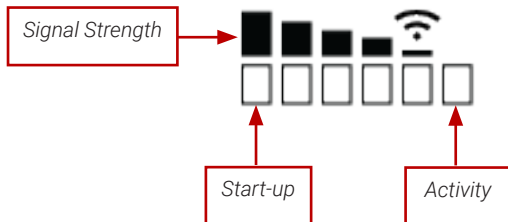

- During the boot process, the Smart-Reach Lite should emit a single audio "beep", and the Start-up LED should illuminate (solid). Otherwise, check device/power connections.
- When the bridge finishes booting, it emits 2 "beeps".
- The Activity LED illuminates to indicate traffic between the bridge and the recorder.
  - If the Activity LED does not illuminate, check connections between the recorder and the Smart-Reach Lite.
- If the Smart-Reach Base (access point) is installed and the vehicle is within range, the Smart-Reach Lite's Signal Strength LEDs indicate a connection to the wireless network.

## Need Help?

Technical Support	1.844.899.7366
Email	PTsupport@safefleet.net

If your Smart-Reach Lite is to be returned, please contact Technical Support, and provide the model and/or serial number of your unit. Ask for a Return Merchandise Authorization (RMA) number. An RMA number allows the Service Technicians to better track your product when it comes in for service. Please show the RMA number on the outside of the package. ANY RETURNED PRODUCT WITHOUT AN RMA NUMBER MAY BE REFUSED.

## Documentation

For product information and documentation, please visit the Safe Fleet Community at <https://community.safefleet.net>.

*Information is subject to change without notice. Please check Safe Fleet Community for the latest version.*

## Warranty

For full warranty information, go to <https://www.seon.com/documents/Seon-Warranty.pdf>.

## Appendix: PoE Injector Installation (SRLAC07/SRLN07)

The SRLAC07 and SRLN07 installation kits for recorders without 12-volt PoE support includes the following additional components:

- PoE Injector (POE-INJ2)
- Ethernet cable 3ft./1.9m (085-0082)
- Injector harness kit (020-0181), including power cable, control cable, and fuse/holder.

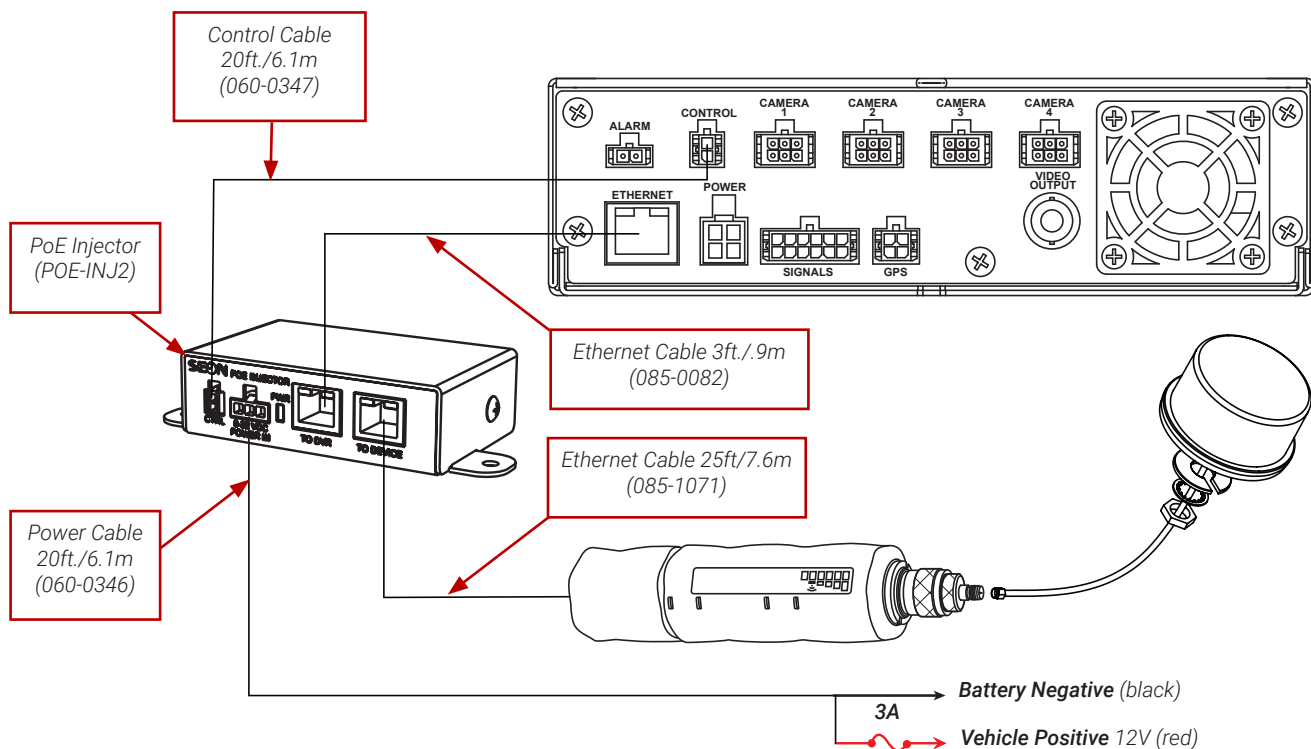

### PoE Injector Connections

1. Connect the bridge Ethernet cable (25 ft./7.6m, 085-1071) jack to the **TO DEVICE** socket on the PoE Injector.
2. Connect the Ethernet cable (3ft./1.9m, 085-0082) from the recorder's Ethernet socket to the **TO DVR** socket on the PoE Injector.
3. Connect the Control cable (060-0347) from the recorder's **CONTROL** socket to the PoE Injector's **CTRL** port.
4. Connect the Power cable (060-0346) from the PoE Injector's **POWER IN** socket to a good battery power source. Be sure to use the supplied fuse and fuse holder.