

Rear Vision System Camera Installation Guide

Camera Installation

Use the following image and steps to install the RVC400 camera:

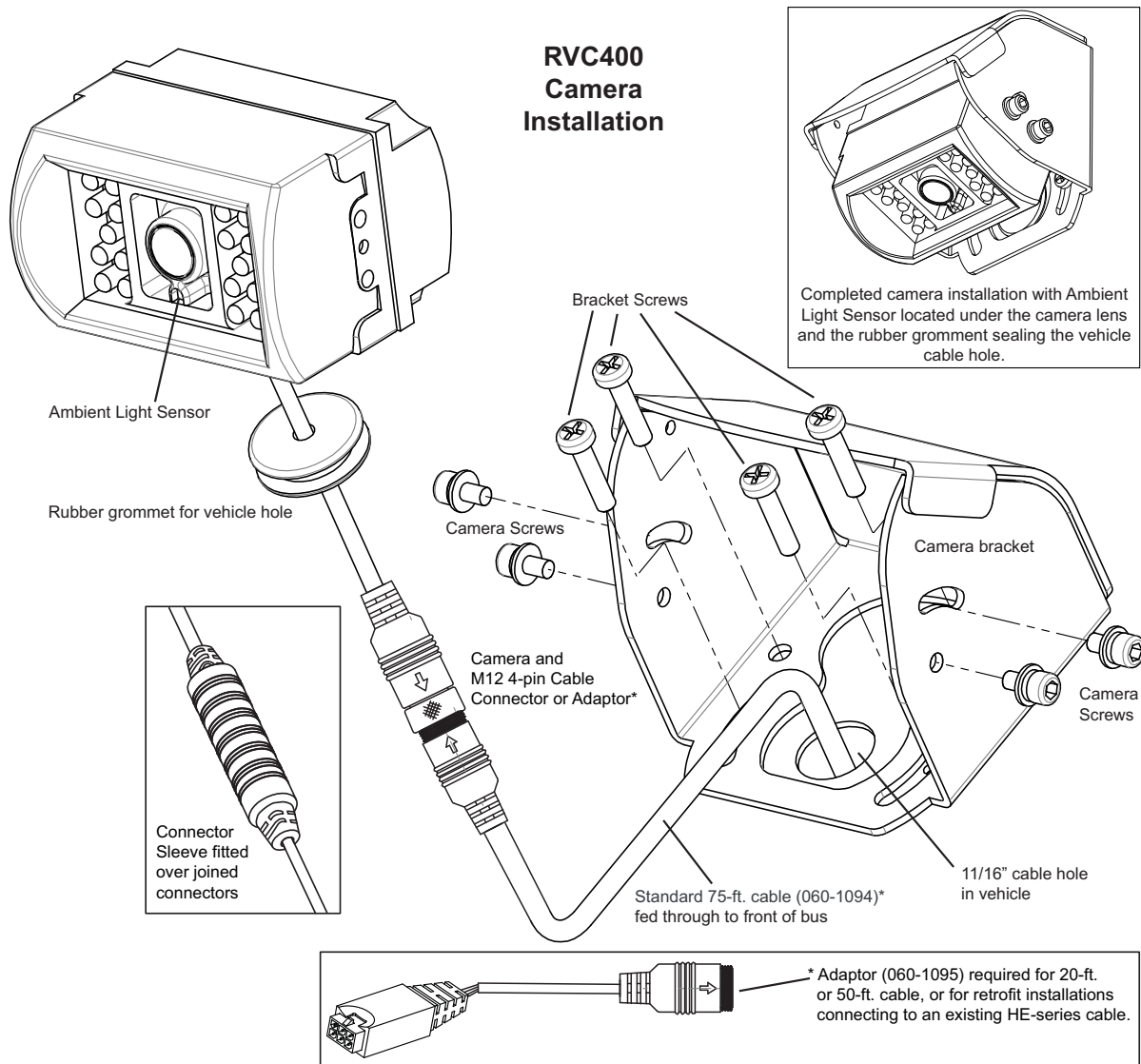

- 1 Select the RVS camera mounting location.
For best results, install the RVS camera high on the vehicle, as close to the center line of the vehicle as possible.
- 2 Drill an 11/16" cable hole through the vehicle panel.
- 3 Run the camera extension cable from the camera hole to the front of the vehicle.
- 4 Using the bracket, mark screw hole locations and pre-drill pilot holes (3.0 mm or 1/8").
- 5 Mount the bracket to the vehicle.
- 6 Connect the camera extension cable to the camera cable* and pull the rubber sleeve over the connection.
** If this is a retrofit installation, or if using an HE-series cable other than the supplied 75-foot cable (060-1094):*
 - a) Connect the 4-pin Mil-spec male end of the adaptor to the 4-pin Mil-spec female coming off the camera pigtail.
 - b) Pull the rubber sleeve over the connection.
 - c) Connect the 2x3 Microfit female end of the adaptor (060-1095) to the 2x3 male end of the existing HE-series cable.
 - d) Tape the ends of the Microfit connectors to keep water and debris out.
- 7 Use the grommet on the camera cable to plug the hole in the vehicle panel.
- 8 Mount the camera in the bracket, using the 4 hex drive screws.

Note the camera orientation – the ambient light sensor must be located under the camera lens.

- 9 Once the monitor has been installed and connected, you will need to return to the camera to aim the view.
- 10 Adjust the camera view so that the bumper of the vehicle is just visible across the bottom edge of the monitor
- 11 Firmly tighten the four mounting screws that hold the camera in place, using the Hex key provided.

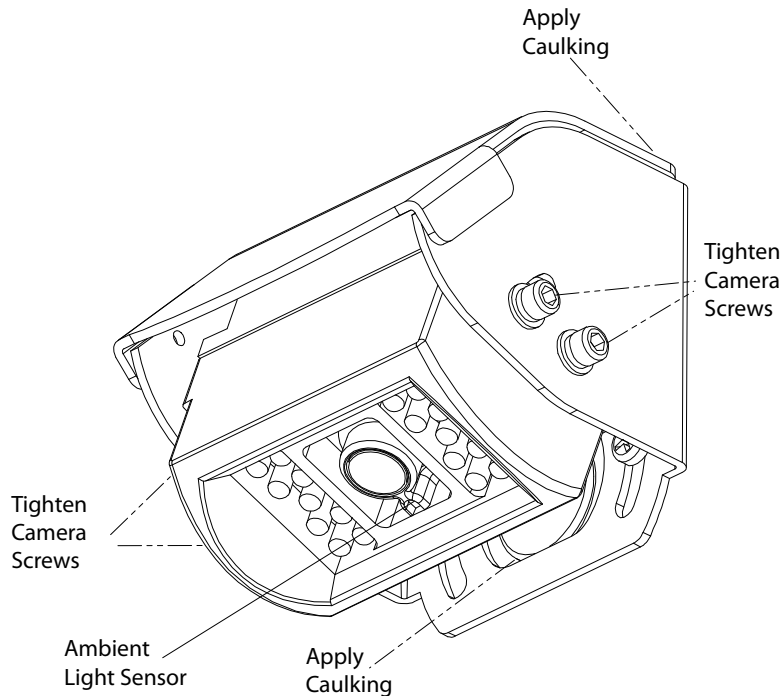

- 12 After the final alignment is complete, apply caulking along the top edge of the bracket, and caulk the cable hole if required.

Warranty

Warranty details are available at:

<http://www.seon.com/documents/Seon-Warranty.pdf>

Product Information

For instructions on RVS power connections, wiring, and configuration, please see the *Rear Vision System Installation Guide* (700-1110, or 700-1109 for splitter hardware). For full product details and access to our document library, please visit the Seon Community Web site:

<https://community.seon.com/documents/>

Please contact Customer Service if you do not have access credentials.

Customer Service Contact Information

- Service 1.844.899.7366
- General Enquiries 1.877.630.7366
- Email: service@seon.com

If your RVS camera is to be returned, please contact Customer Service, and provide the model and/or serial number of your unit. Ask for a Return Merchandise Authorization (RMA) number. An RMA number allows the Service Technicians to better track your product when it comes in for service. Please show the RMA number on the outside of the package. **ANY RETURNED PRODUCT WITHOUT AN RMA NUMBER MAY BE REFUSED.**