

Specifications

Power Consumption	1 W (IR off); 2 W (IR on)
Operating Voltage Range	12 VDC ± 10% (powered by recorder)
Operating Temperature Range	-4 to 122°F (-20 to 50°C)
Resolution	Standard Definition Analog
Infrared LED Lamps	12 LEDs (5mm)
Minimum Illumination	Color: 0.1 lux (F2.0) B&W, IR LED on: 0 lux
Enclosure Size	Diameter : 3.74" (95 mm) Height: 2.64" (67 mm)
Enclosure Material	Solid aluminum alloy
Dome	Impact-resistant polycarbonate, anti-glare, scratch-resistant hardcoating, UV protected
Camera Pigtail Connector Length	12" (30 cm)
Weight	0.642 lbs (0.29 kg)

Routine Maintenance

Most liquid cleaners or graffiti gel can be used to clean your camera enclosure. Do not use abrasive cleaners that can scratch the window and reduce visibility of the camera.

Service & Support

If your HD1Q camera is to be returned for service, please contact the Safe Fleet Technical Support team and provide the part and/or serial number of your unit. Ask for a **Return Merchandise Authorization (RMA) #**. An **RMA #** allows the support team to better track your product when it comes in for service. Please show the RMA # on the **outside** of the package. **ANY PRODUCT SENT WITHOUT AN RMA # MAY BE REFUSED.**

Technical Support

- Email: PTsupport@safefleet.net
- Phone: 1.877.899.7366

Documentation and Warranty

Additional copies of this guide, along with other documentation and product warranty, are available on the SafeFleet Community Web site:

<https://community.safefleet.net>

HD1QxxASDA & HD1QxxAISDA Series Dome Cameras

Quick Installation Guide

Product Overview

This quick install guide applies to the following camera models:*

- HD1QxxASDA, HD1QxxAISDA

For exact model ID: replace "xx" with desired lens size (02=2.6mm, 04=3.6mm).

- * Models without an "I" ship with IR disabled.
Models with an "I" ship with IR enabled.

The HD1Q camera can be installed with or without the supplied angle mount shim. This guide covers both installation types, and provides specific instructions where required.

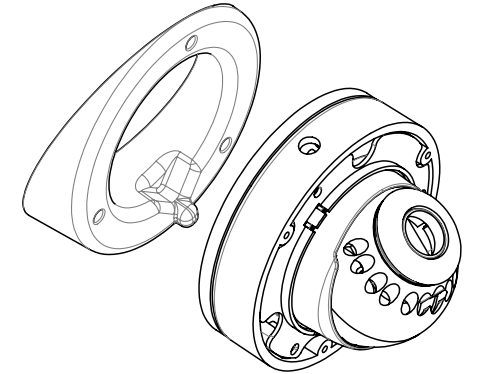

Installation Kit Contents

- 1 HD1Q camera, including dome lid and gasket
- 1 Security key (part # 645-1003)
- 3 x No. 10 screws, with washers * (1" length, part # 600-1021)
- 1 Drilling template (Part # 700-1090) *
- 7 x rubber washers (includes one spare washer), pre-installed on screws (part # 610-1001)
- 1 shim angle mount (part # 665-1017) **
- 2 x No. 10 screws ** (2" length, part # 600-1017)
- 1 x No. 10 screw ** (1.25" length, part # 600-1018)

** For shim installations only

* Not used for shim installations

Step 1: Choose Camera Location

When choosing a camera mounting location, consider the desired field of view, area of focus, and camera/shim assembly orientation. For shim installations, generally the shallow side of the shim should point in the direction of the camera lens.

1. Determine the location for mounting the camera.
 - a. Choose a solid surface to minimize vibration
 - b. Choose a location away from access panels, hatches, or doors which may block the camera view
 - c. Choose a location away from forced-air outlets, as this could affect audio performance.
 - d. Choose a location away from heat sources
 - e. Cameras are usually installed with the cabling running inside the wall panels.
2. Mark the cable (7/8") and screw (5/32") on the panel:
 - For shim installations: use the angle mount shim as a guide.
 - For standard installations: use the supplied drilling template.
3. Use a step-bit to drill the cable hole.

Step 2: Remove Camera Dome

1. Using the security key supplied with the camera, loosen the captive screws on the housing.
2. Lift the housing off of the base.

Step 3: Connect Camera to Recorder

1. *For shim installations only:*
Position the shim against the camera base and pull the pigtail through the center of the shim.
2. Connect the pigtail to the camera harness through the panel cable hole.
3. Connect the camera harness 2x3 Micro-Fit connector to the recorder.

Step 4: Install Camera

Standard Installation

1. Ensure a rubber washer is in place over each of the mounting screws.
2. Use the three No. 10 x 1" mounting screws supplied with the camera to attach the camera to the vehicle.

Installation with Shim Angle Mount

1. Ensure a rubber washer is in place over each of the mounting screws.
2. Use the alignment peg to position the camera base against the shim so the cable notch and the mounting holes line up.
3. Slide one of the longer self-drilling mounting screws (No. 10 x 2") through the camera and the hole at a thicker edge of the shim, and attach it to the vehicle panel.
4. Repeat step 3 with the other 2" mounting screw.
5. Slide the shorter self-drilling mounting screw (No. 10 x 1.25") through the camera and the hole at the thinnest edge of the shim, and fully attach the camera/shim assembly.

NOTE

Take care to ensure all screws are perpendicular to the camera base.

Step 5: Aim Camera

1. With a monitor connected to the recorder, power up the system. The monitor should display the multiple camera views once the recorder is powered up.
2. Double-click a camera to display it in full-screen mode.
3. Aim the camera by tilting and rotating as required.

Step 6: Replace Camera Dome

1. Fit the dome onto the base, ensuring the rubber IR boot around the camera lens is firmly pressed against the inside of the dome.
2. Use the security key to tighten the captive screws.

NOTE: Mounting Post Installation (HD1QxxASDA models)

HD1QxxASDA cameras can optionally be installed with a mounting post kit (not supplied with the camera).

Supported Mounting Post Kits:

- HD1Q-MP4A30 (4-inch)
- HD1Q-MP6A30 (6-inch)

For more information and mounting post installation instructions, see the *Dome Camera Angled Mounting Post Instructions* (part #700-0188), available on the Safe Fleet Community.

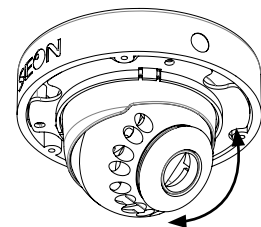
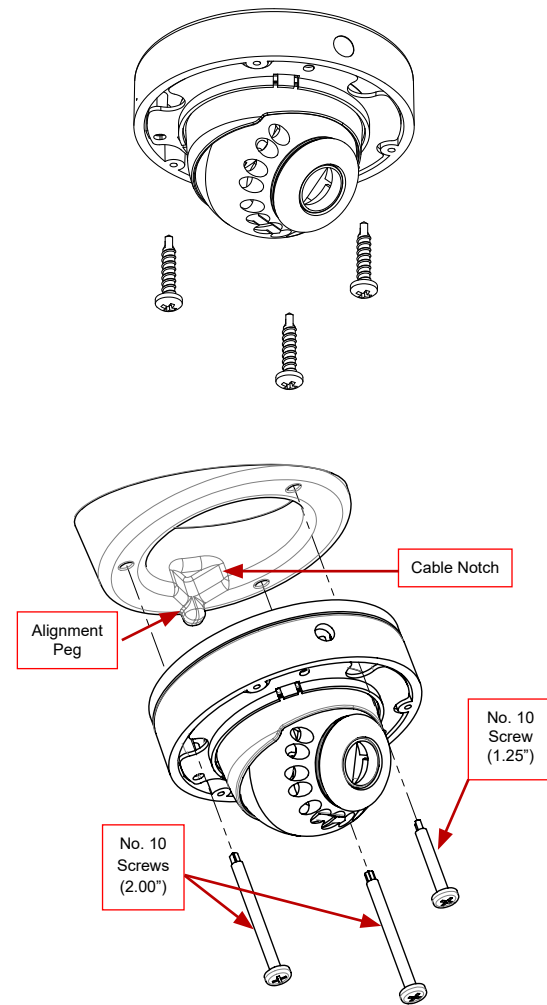
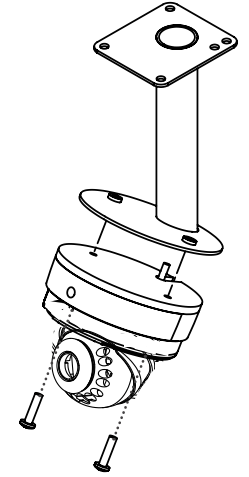

Fold Here