

# HD1Q Series Dome Camera

## Quick Installation Guide

### Specifications

Power Consumption	1 W (IR off); 2 W (IR on)
Operating Voltage Range	12 VDC ± 10% (powered by DVR)
Operating Temperature Range	-4 to 122°F (-20 to 50°C)
Resolution	720p
Infrared LED Lamps	12 LEDs (5mm)
Minimum Illumination	Color: 0.1 lux (F2.0) B&W, IR LED on: 0 lux
Enclosure Size	Diameter : 3.74" (95 mm) Height: 2.64" (67 mm)
Enclosure Material	Solid aluminum alloy
Dome	Impact-resistant polycarbonate, anti-glare, scratch-resistant hardcoating, UV protected
Camera Pigtail Connector Length	12" (30 cm)
Weight	0.642 lbs (0.29 kg)

### Routine Maintenance

Most liquid cleaners or graffiti gel can be used to clean your camera enclosure. Do not use abrasive cleaners that can scratch the window and reduce visibility of the camera.

## Service

If your HD1Q camera is to be returned for service, please call (toll free) **1.877.630.7366** or **1.844.899.7366**, and provide the model and/or serial number of your unit. Ask for a Return Merchandise Authorization (RMA) number. An RMA number allows the Service Technicians to better track your product when it comes in for service. Please show the RMA number on the outside of the package. **ANY PRODUCT SENT WITHOUT AN RMA# MAY BE REFUSED.**

### Technical Support

- Email: [service@seon.com](mailto:service@seon.com)
- Phone: 1.877.630.7366

### Documentation

Additional copies of this guide, along with supporting documentation, are available on the SafeFleet Community:

- <https://community.seon.com/documents/>

## Product Overview

This quick install guide applies to the following camera models:

- HD1QxxAI, HD1QxxAI20, HD1QxxAI50, HD1QxxAI75

This HD1Q camera with IR is designed for interior use only.

The HD1Q camera can be installed with or without the supplied angle mount shim. This guide covers both installation types, and provides specific instructions where required.

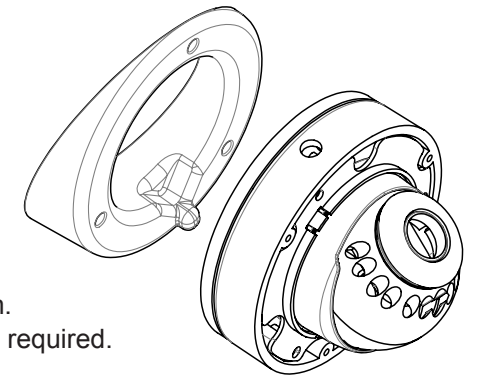

## Installation Kit Contents

- 1 HD1Q camera, including dome and gasket
- 1 Security key (part # 645-1003)
- 3 x No. 10 screws \* (1" length, part # 600-1021)
- 1 Drilling template (Part # 700-1090) \*
- 6 x rubber washers, pre-installed on screws (part # 610-1001)
- 1 shim angle mount (part # 665-1017) \*\*
- 2 x No. 10 screws \*\* (2" length, part # 600-1017)
- 1 x No. 10 screw \*\* (1.25" length, part # 600-1018)

\*\* For shim installations only

\* Not used for shim installations

### WARNING: Camera Harness Cable Compatibility



This camera requires a special Analog High Definition (AHD) camera harness - as indicated by a blue band in front of the connectors. The AHD harness is not included with the camera kit. If you require an AHD harness, please contact our customer service department to place an order.

## Step 1: Choose Camera Location

When choosing a camera mounting location, consider the desired field of view, area of focus, and camera/shim assembly orientation. For shim installations, generally the shallow side of the shim should point in the direction of the camera lens.

1. Determine the location for mounting the camera.
  - a. Choose a solid surface to minimize vibration
  - b. Choose a location away from access panels, hatches, or doors which may block the camera view
  - c. Choose a location away from heat sources
  - d. Cameras are usually installed with the cabling running inside the wall panels.
2. Mark the cable (7/8") and screw (5/32") on the panel:
  - For shim installations: use the angle mount shim as a guide.
  - For standard installations: use the supplied drilling template.
3. Use a step-bit to drill the cable hole.

## Step 2: Remove Camera Dome

1. Using the security key supplied with the camera, loosen the captive screws on the housing.
2. Lift the housing off of the base.

## Step 3: Connect Camera to Recorder

1. *For shim installations only:*  
Position the shim against the camera base and pull the pigtail through the center of the shim.
2. Connect the pigtail to the camera harness through the panel cable hole.  
*Important:* ensure the camera harness cable has a blue band in front of the connectors, indicating it is AHD-compatible.
3. Connect the camera harness 2x3 Micro-Fit connector to the recorder.

## Step 4: Install Camera

### Standard Installation

1. Ensure a rubber washer is in place over each of the mounting screws.
2. Use the three No. 10 x 1" mounting screws supplied with the camera to attach the camera to the vehicle.

### Installation with Shim Angle Mount

1. Ensure a rubber washer is in place over each of the mounting screws.
2. Use the alignment peg to position the camera base against the shim so the cable notch and the mounting holes line up.
3. Slide one of the longer self-drilling mounting screws (No. 10 x 2") through the camera and the hole at a thicker edge of the shim, and attach it to the vehicle panel.
4. Repeat step 3 with the other 2" mounting screw.
5. Slide the shorter self-drilling mounting screw (No. 10 x 1.25") through the camera and the hole at the thinnest edge of the shim, and fully attach the camera/shim assembly.

#### NOTE

Take care to ensure all screws are perpendicular to the camera base.

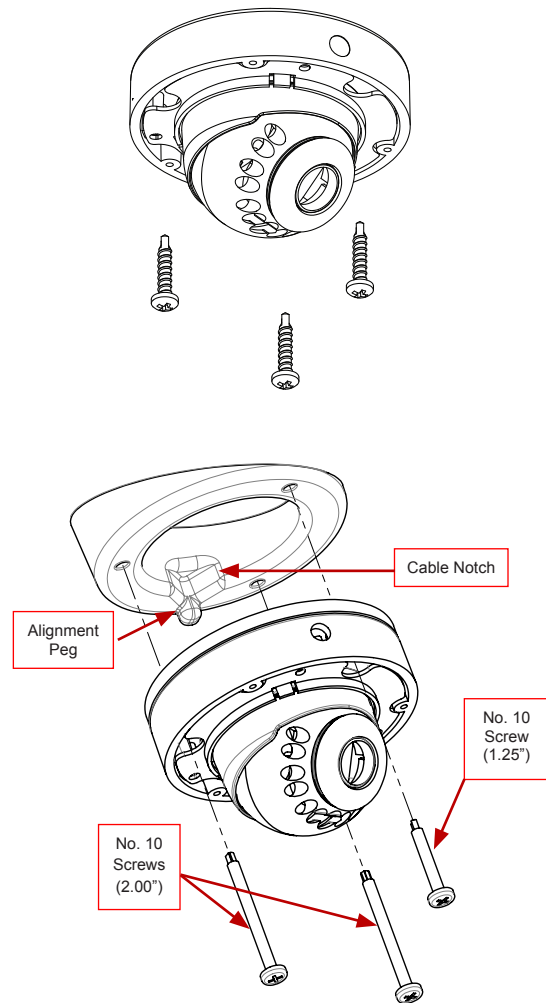

## Step 5: Aim Camera

1. With a monitor connected to the recorder, power up the system. The monitor should display the multiple camera views once the recorder is powered up.
2. Double-click a camera to display it in full-screen mode.
3. Aim the camera by tilting and rotating as required.

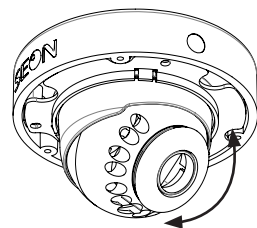

## Step 6: Replace Camera Dome

1. Fit the dome onto the base, ensuring the rubber IR boot around the camera lens is firmly pressed against the inside of the dome.
2. Use the security key to tighten the captive screws.

## Step 7: Configuration Settings for Forward-facing Applications

*For improved image quality in forward-facing camera applications (through the windshield), we recommend the following procedure to disable infrared (IR) LEDs, enable the external light sensor to automatically control Day/Night modes, and turn off the Backlight setting:*

1. Open the recorder's on-screen display **Camera Advanced** tab:  
**Configuration → Record → Camera → Camera Advanced**
2. Click the tab for the camera you want to configure.
3. Click **Set** to display the camera configuration **MAIN MENU**.
4. Use the up/down arrows to select option 5, **DAY&NIGHT** (a triangle pointer appears to the left of the option).
5. Use the left/right arrows to cycle through settings until the **B/W** option appears in the right-hand column.
6. Click **Set** to open the **B/W** menu.
7. Use the down arrow to select **IR**.
8. Click the left or right arrow to toggle the **IR** setting (option 4) **OFF**.
9. Use the down arrow to select **RETURN**, then click **Set** to re-display the main menu.
10. In the main menu, with the **DAY&NIGHT** option selected, use the left or right arrow to cycle through settings until the **EXT** option appears in the right-hand column.
11. Use the up arrow to select option 3, **BACKLIGHT**.
12. Use the left or right arrow to cycle through settings until **OFF** appears in the right-hand column.
13. When you're done, use the up/down arrows to select option 9. **EXIT (SAVE & END)**, then click **Set** to save your settings and close the menu.
14. Click **Back** repeatedly to exit Configuration menus.

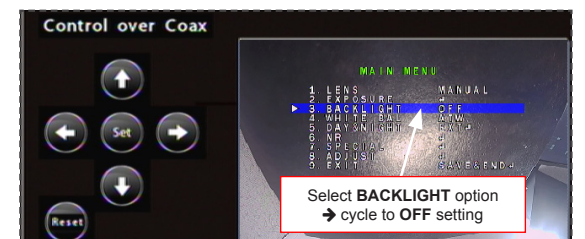
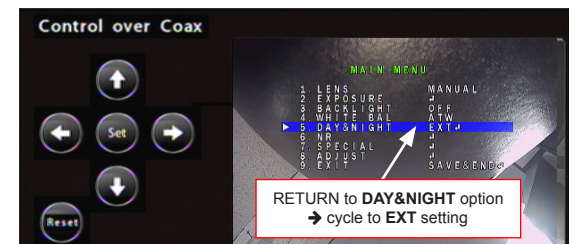
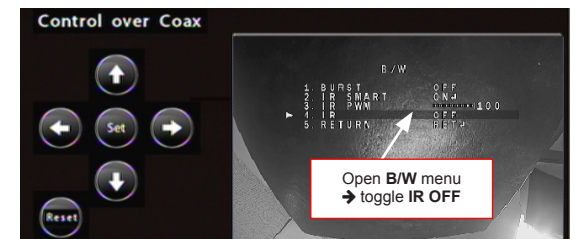
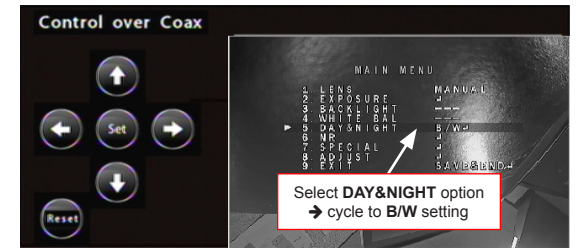

Fold Here