

CMD1004E Exterior Dome Camera

Quick Installation Guide

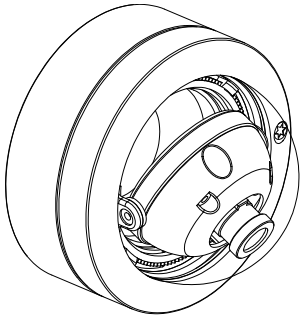

© Seon Design Inc. | 2020 | All rights reserved. Part Number: 700-1031 R2

Installation Kit Contents

- 1 Exterior Dome camera, base, and 4 M4 0.7x 1.0mm screws
- 4 #8x 3/4" Phillips screws
- 1 Torx key
- 1 Quick Installation Guide
- 1 Drilling template
- 1 Base gasket

Choose Camera Location

Determine the location for mounting the camera. Select a flat location to minimize moisture leakage into the vehicle. Cameras must be installed with the cabling running inside the wall panels.



CAUTION: Vehicle Leakage Risk

For outdoor installations, if a flat surface is not available, seal the mounting holes under the base of the camera after installation.

Install the Camera Base

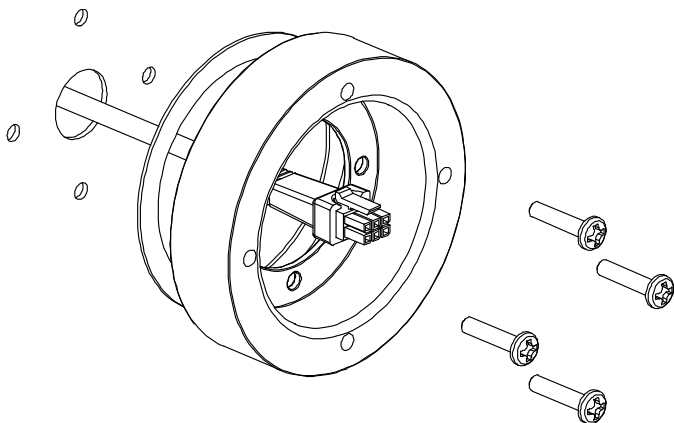

1. Use the supplied Surface Type mounting template to mark the cable (11/16") and screw (1/8") holes on the panel.
2. Use a step-bit to drill the cable hole, and regular bits for the screw holes.

3. Apply the gasket to the camera base.
4. Pull the camera extension cable from the DVR to the camera location.
5. Use the four supplied #8 x 3/4" Phillips screws to install the camera base to the vehicle surface.

Open the Camera Assembly

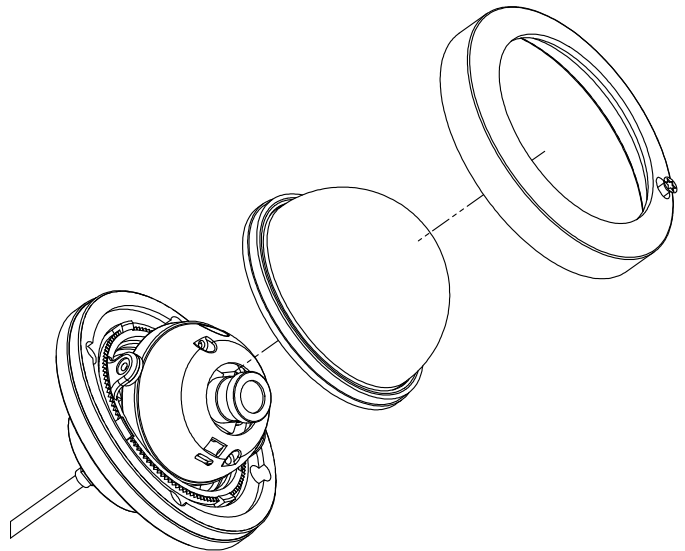

1. Use the supplied Torx key to loosen the screw on the camera bezel.
2. Unthread the bezel from the camera assembly.
3. Remove the bezel and the camera dome from the camera assembly.
4. Connect the 2x3 microfit cable from the camera assembly to the extension cable.
5. Pull the connected cabling back into the bus.

Attach the Camera to the Base

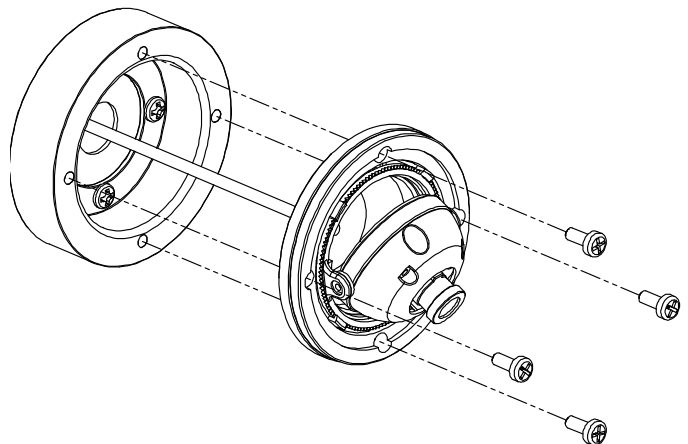

Screw the camera assembly to the mounted camera base using the four supplied M4 0.7x10mm screws.

Aim the Camera

To get the required video image, adjust the camera's rotation, pan, and tilt settings using the adjustment controls and the DVR monitor video output.

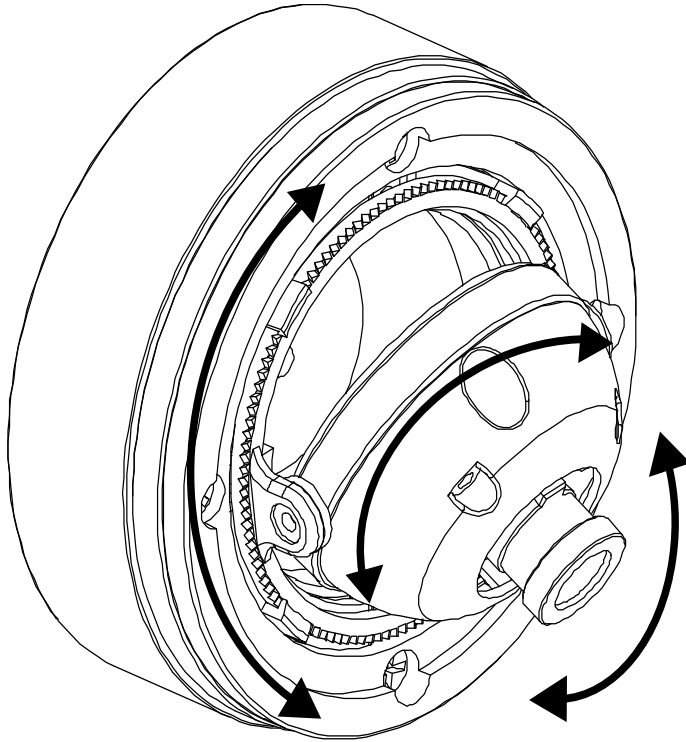

Rotation: depending on how the camera is mounted, grip the tilt screws and rotate the camera assembly to ensure the camera shows a level view.

Pan: grip the camera gimbal while holding a finger or thumb against the tilt screwmount and twist it to find the required view.

Tilt: loosen the tilt adjustment screws until the camera can tilt. Tighten the tilt screws after adjustments are complete. Do not adjust tilt after tightening screws. Do not adjust any other screws.

Close the Camera

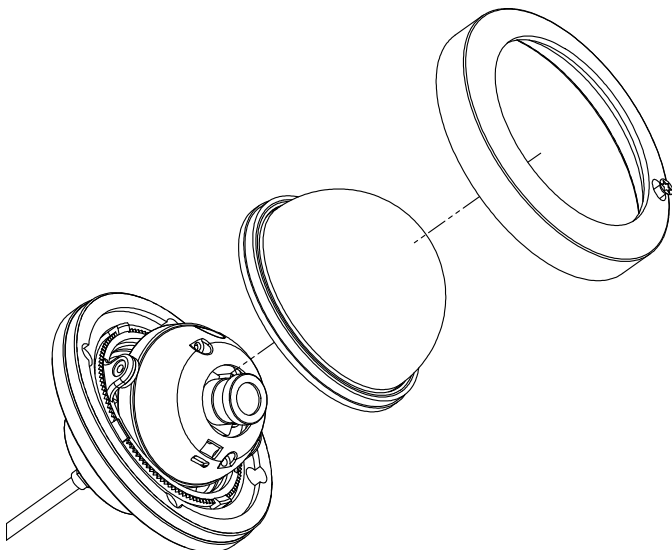

1. Replace the dome and bezel on the camera assembly.
2. Use the supplied Torx key to tighten the security screw on the camera bezel.

Specifications

Power Consumption	1.68 W (Max)
Operating Voltage Range	7 to 18 VDC (powered by DVR)
Operating Temperature Range	- 4 to 158°F (-20 to 70°C)
Horizontal resolution	800 TV Lines
Enclosure Size	Diameter: 3.125" (80 mm) Height: 2.625" (67 mm)
Enclosure Material	Solid aluminum alloy
Connector Cable Length	12" (30 cm)

Routine Maintenance

Most liquid cleaners or graffiti gel can be used to clean your camera enclosure. Do not use abrasive cleaners that can scratch the window and reduce visibility of the camera.

If the window in your camera is damaged or scratched beyond use, order a replacement window from your camera distributor.

Replacing a Damaged Dome

1. If the camera dome is damaged or scratched, order a replacement bezel and dome assembly from your camera distributor.
2. To remove and replace the bezel and dome, follow the steps in **Open the Camera Assembly** and **Close the Camera**.

Service & Support

If your CMD Exterior Dome Camera is to be returned for service, please contact the Safe Fleet Technical Support team, provide the model and/or serial number of your unit, and ask for a Return Merchandise Authorization (RMA) number.

An RMA number allows the support team to better track your product when it comes in for service. Please show the RMA number on the **outside** of the package.

ANY PRODUCT SENT TO SAFE FLEET WITHOUT AN RMA NUMBER MAY BE REFUSED!

Documentation & Warranty

Additional copies of this guide, along with other documentation and the product warranty can be found on the Safe Fleet Community Web site:

<https://community.safefleet.net>

Technical Support

Phone: **1.844.899.7366**
(Mon.-Fri., 7:00am-7:00pm EST)

Email: PTsupport@safefleet.net



2002/96/EC (WEEE directive): This product cannot be disposed of as unsorted municipal waste in the European Union. For proper recycling, return the product to your local supplier upon the purchase of equivalent new equipment, or dispose of it at designated collection points, for more information, see www.recyclethis.info.

2006/66/EC (battery directive): This product does not contain batteries.