

Accessing the Camera using a web browser

You can use a web browser to access and configure the camera over the Internet.

For a direct connection to a single camera:

1. Using a Web browser, enter the camera's IP address (default is **172.30.1.1**). The Login dialog box appears.

Note: Ensure that the Active X controls are enabled.

2. Enter your user name and password. Default user name is **Admin** and default password is **11111111**.
3. Click Login. The web browser window appears.

If you want to access a camera connected to a PoE Switch (part #: NS18POE16), the IP address of each camera varies:

- Channel 1: **172.31.1.101**
- Channel 2: **172.31.1.102**
- Channel 3: **172.31.1.103**, etc.
- Channel 16: **172.31.1.116**

Support

- Phone: 1-844-899-7366
- Email: service@seon.com

Documentation

Additional copies of this guide, along with other supporting documentation can be found on the Safe Fleet Community:

- <https://community.seon.com/documents/>



2002/96/EC (WEEE directive): This product cannot be disposed of as unsorted municipal waste in the European Union. For proper recycling, return the product to your local supplier upon the purchase of equivalent new equipment, or dispose of it at designated collection points, for more information, see www.recyclethis.info.

2006/66/EC (battery directive): This product does not contain batteries.



C3Q9PD

Quick Install Guide

For camera models:

C3Q9PD03A, C3Q9PD03A-BK, C3Q9PD03AF-BK,
C3Q9PD04A, C3Q9PD04A-BK, C3Q9PD04AF-BK

Package Contents

Check the package and contents for visible damage. If any components are damaged or missing, contact the Seon Service team and request an RMA (Return Material Authorization).

Package contents:

- Camera
- Torx Security Wrench
- Drill Template
- Lens Adjusting Tool
- Qty 2 - #8, 1" Mounting Screws
- Weatherproof cap for RJ45 connector

Cable Requirements

It is recommended that camera harnesses be purchased directly from Safe Fleet. All network cabling must be installed according to applicable codes and regulations.

Cable should be CAT5e or CAT6, stranded or solid, 24 AWG or better. Both ends must be terminated with male RJ45 connectors and should conform to TIA/EIA-568-B standards. Spliced cables are not acceptable.

Service

If your C3Q9PD Camera is to be returned for service, please call toll free 1.877.630.7366, or 1.844.899.7366, and provide the model and/or serial# of your unit.

Ask for a Return Merchandise Authorization (RMA) number. An RMA# allows the Service Technicians to better track your product when it comes in for service. Please show the RMA# on the outside of the package. ANY PRODUCT SENT WITHOUT AN RMA# MAY BE REFUSED.

Warranty

For full warranty information, visit:
www.seon.com/documents/Seon-Warranty.pdf

Installation Environment

When installing your product, consider the following:

- **Electrical:** Install electrical wiring carefully. This should be done by qualified service personnel. Always use a proper PoE switch to power the camera.
- **Ventilation:** Ensure that the location planned for the installation of the camera is well ventilated.
- **Temperature:** Do not operate the camera beyond the specified temperature, humidity, or power source ratings. The operating temperature of the camera is between -20°C and +60°C.
- **Servicing:** Do not attempt to repair this camera yourself. Any attempt to dismantle this product, except as required for normal installation, will negate the warranty and may also result in injury. Refer all servicing to qualified service personnel.
- **Cleaning:** Do not touch the lens with your fingers. If cleaning is necessary, use a clean soft cloth with isopropyl alcohol and gently wipe the camera.

Camera Components

1. Cover
2. Lens
3. Ethernet RJ45 cable

4. BNC Cable
5. Base
6. Reset Button

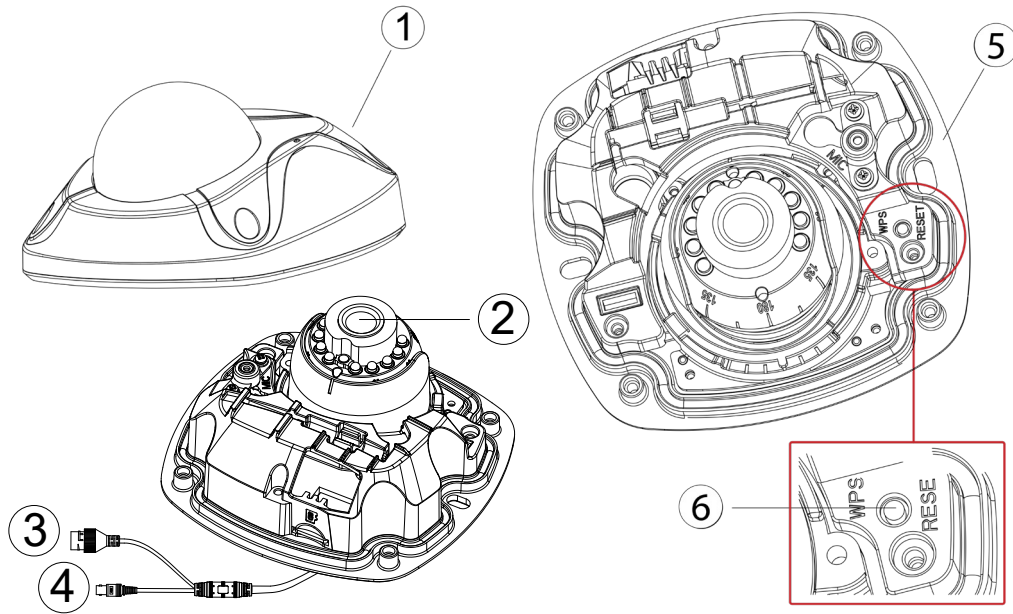

4. Loosen the adjusting screw (3) to adjust the pan, tilt, and angle with the adjusting cap, then re-tighten the screw.
5. Check that the foam ring (4) around the lens is not covering the ambient light sensor.
6. Make sure the rubber cap is still present over the microphone (5).
7. Finally, re-install the cover using the cover screws.

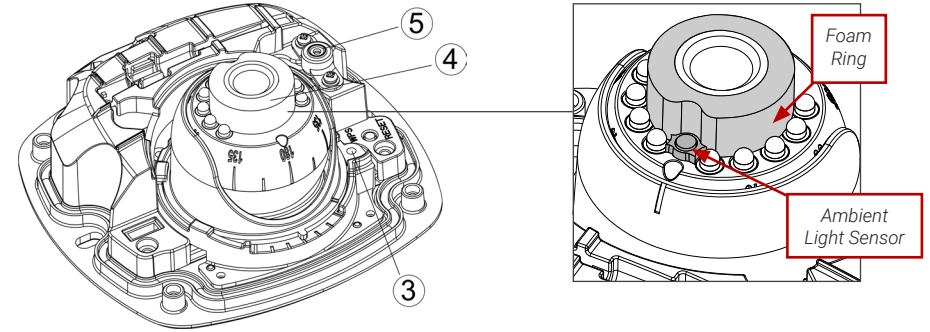

Mounting the Camera

1. Use the supplied template to mark out the mounting area. Drill the screw holes on the surface.
2. Loosen the cover screws to remove the cover from the camera and fix the mounting base to the ceiling with the appropriate screws.
3. Align the supplied adjusting cap (1) and fix it to the small lens adjusting holes on the camera (2).

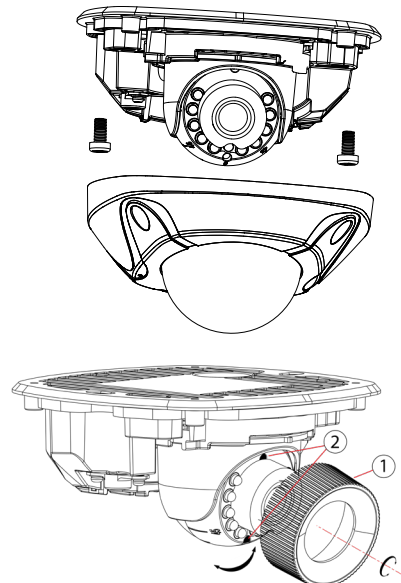

Fold Here

Warning: Blocking the Ambient Light Sensor ⚠

Take caution when positioning the lens, ensuring that the ambient light sensor is always unobstructed when the camera is fully assembled. An obstructed sensor will prevent the camera from working properly.

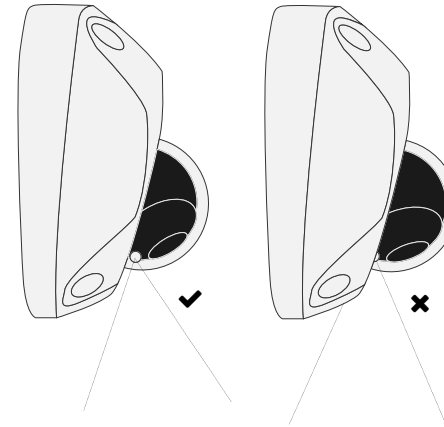

Important: Positioning the Lens ⓘ

The ambient light sensor must be pointed downwards (or at the "6:00" position) when positioning the lens. If the sensor is facing up (or at the "12:00" position), then the image will be upside-down.

